

ITEM TECHNICAL CARD

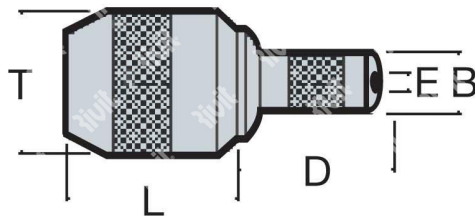

|                                |       |
|--------------------------------|-------|
| BR Durchmesser (mm)            | 3,0   |
| E - Nasenloch Durchmesser (mm) | 6,1   |
| T - Kopfbreite                 | 31,8  |
| Endform                        | flach |
| B - Kopfbreite (mm)            | 10,41 |
| L - länge (mm)                 | 34,0  |
| D - Nasenlänge (mm)            | 29,97 |

|   |       |  |   |   |
|---|-------|--|---|---|
| DESCRIZIONE \ DESCRIPTION:<br><b>SC 3,0-Standard head</b> |       | CATEGORIA \ CATEGORY:  |   | <b>5998800</b>  |
| MATERIAL \ MATERIAL:                                      |       | TRATTAMENTO TERMICO \ HEAT TREATMENT:  |   | NOTE \ NOTES:   |
| ESEGUITO DA \ DRAWN BY:<br><b>RIVIT</b>                   | DATA: | TRATT. SUPERFICIALE \ SURF. TREATMENT:   | Rugosità superficiale generale:<br>General surface roughness: |   |
| CONTROLLATO DA \ CHECKED BY:<br><b>RIVIT</b>              | DATA: | PROFONDITÀ TRATTAMENTO TERMICO (SURF) [mm]:<br>HEAT TREATMENT (SURF) DEPTH [mm]: | <b>NON SCALARE IL DISEGNO<br/>DO NOT RESIZE THE DRAW</b>      |   |
| APPROVATO DA \ APPROVED BY:<br><b>RIVIT</b>               | DATA: | DUREZZA \ HARDNESS:  | FOGLIO \ SHEET:<br><b>1 OF 1</b>                              | FORMATO FOGLIO:<br>SHEET FORMAT: <b>A4</b>              |
|   |       | PESO \ WEIGHT:   | Scale \ SCALE:  | CARTIGLIO \ FORMAT<br><b>Mod.P023_07</b>                |
|   |       |  |   |   |
|   |       |  |   | <br><b>FASTENERS &amp; TOOLS</b><br><br><b>RIVIT.IT</b> |