

ITEM TECHNICAL CARD

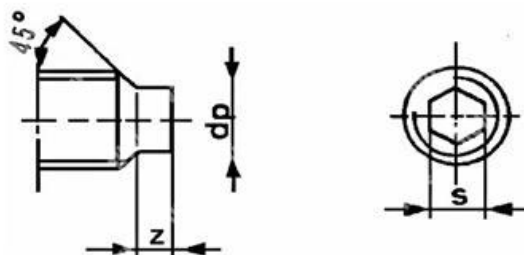

s (mm)	3,0
D (mm)	4,0
Länge (mm)	20,0
Material	Edelstahl A2
Durchmesser	M6
UNI	5925
DIN	915
ISO	4028
t (mm)	3,5
Normative Beschreibung	Gewindestifte Zapfen Innensechskant
faden	1,0
z (mm)	3,0

DESCRIZIONE \ DESCRIPTION: <b>Socket set screws with dog point 5925/DIN 915 stainless steel 304</b>			CATEGORIA \ CATEGORY: <b>0341800.00200</b>	
MATERIAL \ MATERIAL:		TRATTAMENTO TERMICO \ HEAT TREATMENT:		NOTE \ NOTES:
ESEGUITO DA \ DRAWN BY: <b>RIVIT</b>	DATA:	TRATT. SUPERFICIALE \ SURF. TREATMENT:	Rugosità superficiale generale: General surface roughness:	
CONTROLLATO DA \ CHECKED BY: <b>RIVIT</b>	DATA:	PROFONDITÀ TRATTAMENTO TERMICO (SURF) [mm]: HEAT TREATMENT (SURF) DEPTH [mm]:	<b>NON SCALARE IL DISEGNO DO NOT RESIZE THE DRAW</b>	
APPROVATO DA \ APPROVED BY: <b>RIVIT</b>	DATA:	DUREZZA \ HARDNESS:	FOGLIO \ SHEET: <b>1 OF 1</b>	FORMATO FOGLIO: SHEET FORMAT: <b>A4</b>
		PESO \ WEIGHT:	Scale \ SCALE:	CARTIGLIO \ FORMAT <b>Mod.P023_07</b>



**FASTENERS  
& TOOLS**  
RIVIT.IT